

## **N** WARRANTY

A 12 MONTH WARRANTY COVERING DEFECTS IN MATERIAL AND CONSTRUCTION IS SUPPLIED WITH ALL POMPI PIUSI PRODUCTS. WARRANTY IS EXTENDED TO ANYONE IN POSSESSION OF THE PRODUCT DURING THE WARRANTY PERIOD.

WARRANTY IS LIMITED TO REPAIR WORK OR REPLACEMENT OF THE PRODUCT. SUCH OPERATIONS SHALL BE CARRIED OUT EXCLUSIVELY AT THE POMPI PIUSI FACTORY. ANY PRODUCT FOR WHICH INTERVENTION UNDER WARRANTY IS REQUIRED SHALL REACH POMPE PIUSI BY PRE-PAID TRANSPORT.

NO WARRANTY WILL BE RECOGNIZED IN THE FOLLOWING CASES:  
- THE PRODUCT HAS NOT BEEN USED OR INSTALLED IN COMPLIANCE WITH THE MANUFACTURER'S INSTRUCTIONS  
- THE PRODUCT HAS BEEN MODIFIED OR TAMPERED WITH.

## USE AND MAINTENANCE MANUAL

# ST EXTRA ST SUPERPIUSI

**PIUSI**<sup>®</sup>

M0020 REV.A

## A INDEX

- A** Index;
- B** Manufacturer and Equipment Identification Information;
- C** Service;
- D** Equipment Description;
- E** Technical Data;
- F** Standard accessories;
- G** Fluids; H Assembly / preparation;
- I** Malfunctions;
- L** Maintenance;
- M** Single Parts Breakdown and Spare Parts List;
- N** Conditions of Warranty

## B MANUFACTURER AND EQUIPMENT IDENTIFICATION INFORMATION

**MODEL:** ST EXTRA - ST SUPERPIUSI

**MANUFACTURER:** "PIUSI"  
46029 SUZZARA ITALY

**DISTRIBUTOR:**

## C SERVICE

TECHNICAL ASSISTANCE UNDER WARRANTY, SPARE PARTS / MAINTENANCE:

## D EQUIPMENT DESCRIPTION

SELF PRIMING ROTATING ROLLER PUMP WHICH CAN BE CONNECTED TO THE TRACTOR POWER TAKE-OFF.

## E TECHNICAL DATA

### E1 CHARACTERISTICS

	ST EXTRA	ST SUPERPIUSI
Maximum operating pressure	12 bar	15 bar
Maximum tolerable pressure	24 bar	30 bar
Maximum speed	540 r.p.m.	600 r.p.m.
Key coupling	1" 3/8 DIN 9611	1" 3/8 DIN 9611
Weight	14 Kg	14 Kg

### E2 OPERATION DIAGRAM

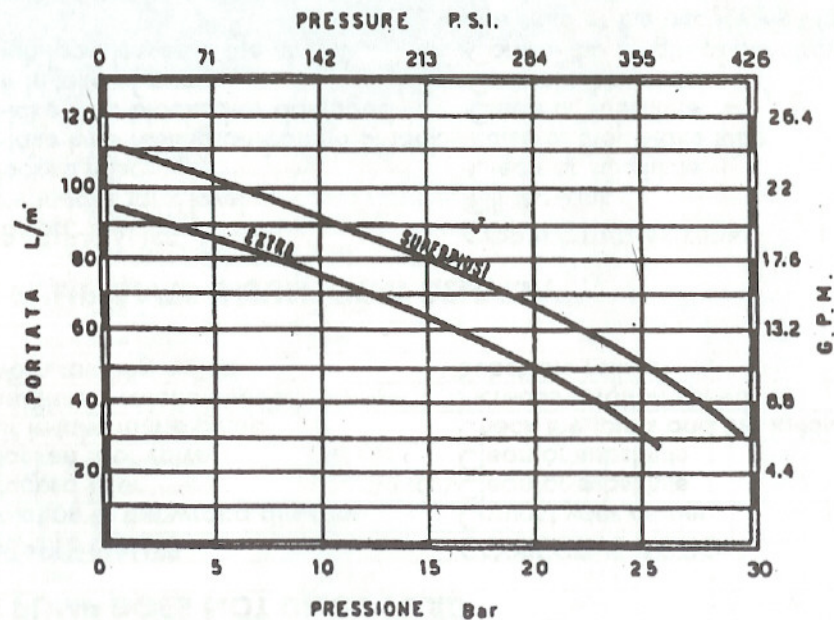

## E4 OVERALL DIMENSIONS AND DIRECTION OF ROTATION

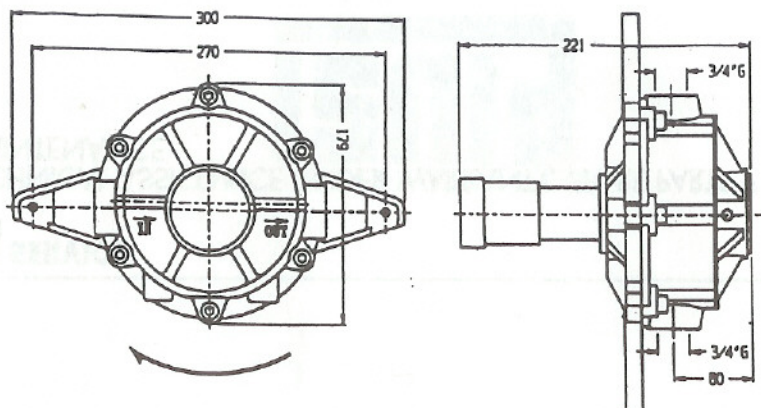

## F STANDARD ACCESSORIES

Fixed launcher ( 5 mm diameter )  
In-take tube ( length 3 m ; internal diameter 25 mm )  
Delivery tube ( length 7 m ; internal diameter 16 mm )  
Fittings  
In-take filter

## G FLUIDS

### G1 ALLOWED

- Water
- Water solutions of products used in agriculture such as: fertilizer, fungicides, weed killers

### G1 NOT ALLOWED

- Strong acid solutions
- Liquids containing solids (particles of soil or gravel)
- Dirty water
- Alimentary liquids

### RELATIVE DANGERS

- Toxic - can irritate if swallowed or comes into contact with the skin
- pollutant - corrosive
- Wear and tear of pump components
- Toxic - pollutant
- Pollution of products

## I MALFUNCTION

### THE PUMP DOES NOT DRAW FLUID

#### PROBABLE CAUSE

- 1- Rotation in the wrong direction
- 2- Blocked filter
- 3- Blocked foot valve
- 4- Air in-take in the pump
- 5- Insufficient rotation speed
- 6- Worn rotating rollers

#### CORRECTIVE ACTION

- Contact your dealer
- Clean or substitute
- Clean or substitute
- Check the joints and the in-take tubes
- Increase rotation speed
- Substitute rollers

### THE PUMP GIVES INSUFFICIENT DELIVERY

#### PROBABLE CAUSE

- 1- Low in-take tank level
- 2- Blocked filter
- 3- In-take tube resting on bottom of tank
- 4- In-take tube blocked or damaged
- 5- Air in-take of pump
- 6- High load losses in the circuit

#### CORRECTIVE ACTION

- Fill the tank
- Clean or substitute
- Raise of the in-take tube
- Clean or substitute
- Control tube joints
- Control the length of the circuit and the state of the accessories in use
- Increase rotation speed

## L MAINTENANCE

THE ST EXTRA AND ST SUPERPIUSI PUMPS HAVE BEEN DESIGNED AND BUILT TO REQUIRE MINIMUM MAINTENANCE.

AFTER USE CAREFULLY WASH THE PUMP RUNNING IT WITH CLEAN WATER, LUBRICATE THE PUMP BY POURING ABOUT 10 CC OF LUBRICATING OIL INTO THE IN-TAKE CONNECTION AND ROTATE BRIEFLY.

- Periodic inspections should be carried out on the joints and tube fittings to detect any eventual leaks.
- The pump should always be kept clean to allow immediate detection of any eventual leaks.
- In case of leaks the gaskets on the pump and on the tubes must be substituted immediately.
- The filter must be removed and cleaned every 20 hours of operation or more often if necessary.

## H ASSEMBLY / PREPARATION

### H1 PRELIMINARY CONTROLS

Check that the equipment has not been damaged during transportation or storing.

Clear in-take and delivery heads of dust and any residual packaging material.

Check that the rotor rotates freely and easily

Before connecting the tubes lubricate by pouring 10 c.c. of lubricating oil into the take-in head and turn by hand.

### H2 INSTALLATION OF COMPRESSOR TO POWER TAKE-OFF

Installation to the power take-off can only be carried out using the coupling wrench supplied.

Do not apply force and secure the screws with the wrench supplied.

Check that the pump is firmly anchored and that there is no axial or radial movement. Anchor the chains to the draw bar making sure that they are taut, parallel and vertical.

Do not use anchoring equipment other than the chains supplied.

### H3 TUBE CONNECTIONS

If conical fittings are used do not use force when fixing them as this can cause damage to the pump housing.

The filter should always be installed on the in-take tube.

In-take tubes: Internal diameter 25 mm  
Max. Pressure 10 bar

Delivery tubes: Use tubes suitable for operating under suction pressure

Internal diameter 16 mm  
Max. Pressure 10 bar

### H4 INSTALLATION OF FIXED PROTECTION

The tractor must be equipped with fixed protection, in conformance with the applicable rules and regulations, which provides protection from unintentional contact with moving parts.

### H5 START UP AND OPERATION

Fix the ends of the in-take and delivery tubes before start-up to avoid dispersion. Dry functioning is allowed only during start up phase.

## M SINGLE PARTS BREAKDOWN - SPARE PARTS LIST

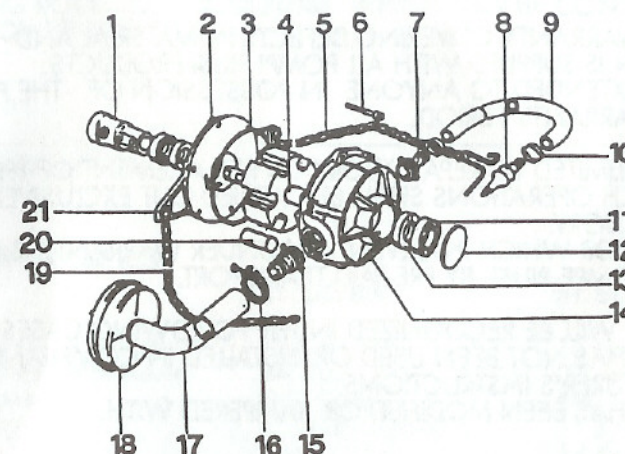

### SPARE PARTS LIST

POMPA			ST EXTRA COD. PF300		SUPERPIUSI COD. PF301	
POS.	DESCRIPTION	MATERIAL	MARK	No.Pz.	MARK	No.Pz.
1	Coupling with grub-screw	Alluminium+Steel	6564	1	6564	1
2	Support	G20 UNI 5007	7074	1	7074	1
3	OR 3525	NBR 70	6832	1	6832	1
4	Rotor with inox shaft	Steel+G20	6585	1	6585	1
5	Securing chain with wrench	Galvanized Steel	6896	1	6896	1
6	Screw TCEI M8x25	Steel 8.8	7075	6	7075	6
7	Outlet hose connection	Brass	6493	1	6493	1
8	Washing jet	Brass	6498	1	6498	1
9	Outlet hose D.16	Rubber	PF903	Mt.7	PF903	Mt.7
10	Outlet hose collar	Steel	407	2	407	2
11	Ball Bearing 6205-2ZR		6335	2	6335	2
12	Name plate Extra	Alluminium	6115	1	6526	1
13	Seal BASL 25x52x9	72	6754	2	6754	2
14	Pump casing Extra	NBR 902	6785	1	6892	1
15	Inlet hose connection	G20 UNI 5007	6492	1	6492	1
16	Inlet hose collar	Brass	406	1	406	1
17	Inlet hose D.25	Steel	PF901	Mt.3	PF901	Mt.3
18	Filter	Rubber	411	1	411	1
19	Chain with hook	Plastic	6066	1	6066	1
20	Roller	Galvanized Steel	6516	6	6516	6
21	Securing bolt	Delrin Galvanized Steel	7119	2	7119	2